

Instruction Manual

Thank you for choosing a quality product from motogadget.

The grip and its components may be damaged easily if mounted improperly. Please read the advice given below carefully and follow them when mounting your turn indicator.

THIS PRODUCT IS EXCLUSIVELY PERMITTED TO BE USED AS GRIP FOR 22 CM / 1 IN. MOTORCYCLE HANDLEBARS WITH CORRESPONDING THROTTLE HANDLES.

THE CASING MAY NOT BE MANIPULATED. IN CASE OF MECHANICAL DAMAGES ALL WARRANTY IS VOIDED. IF THE DEVICE IS USED FOR OTHER PURPOSES THAN THOSE INTENDED, ALL WARRANTIES WILL BECOME VOID. MOTOGADGET ACCEPTS NO LIABILITY FOR DIRECT OR INDIRECT DAMAGES OF ANY KIND RESULTING FROM USAGE, INSTALLATION OR CONNECTION OF THE INSTRUMENT OR INCLUDED ACCESSORIES. THESE ARE, AMONG OTHERS, DAMAGES TO PERSONS, GOODS AND FINANCIAL ASSETS. ESPECIALLY THE USAGE ON PUBLIC ROADS IS AT THE CUSTOMER'S OWN RISK.

Layout

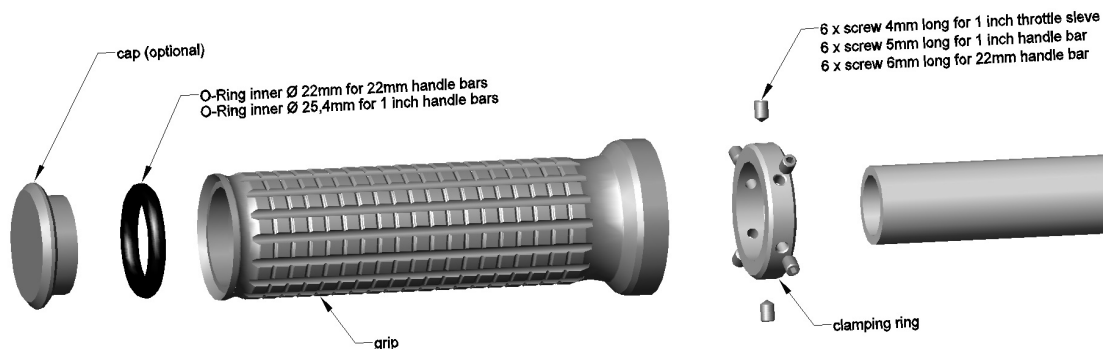

Preparing

- manually screw the clamping ring **counter-clockwise** completely into the casing of the grip (Attention! left-handed thread!).
- choose a fitting O-ring grease it with silicon oil and apply the O-ring into the groove inside the grip end.
- Screw the end cap by using screw adhesive onto the handle (does not apply if using handlebar end type turn indicators). Tighten the cap with a long screw driver through the grip bore
- Push your grip to the desired position on the handlebar and orient the end cap logo horizontally. Shorten the handlebar if necessary.
- With a pen, mark the position of the grip on the handlebar with a line to clamping ring and handle bar.
- Unscrew the tension ring from the grip and screw 6 grub screws (fitting your type of handlebar or throttle grip resp.) into the clamping ring. Choose your screw length according to the table below:
 - Grub screw, 6 mm: 22 mm OD handlebar
 - Grub screw, 5 mm: 1 in. OD handlebar
 - Grub screw, 4 mm: throttle grip bushing

Mounting the left grip

- Push the clamping ring to the handlebar mark applied earlier and carefully and evenly tighten the grub screws

IMPORTANT! THE CLAMPING RING HAS TO BE ALIGNED PERFECTLY CONCENTRIC WITH THE HANDLEBAR. E. G. ALL GRUB SCREWS HAVE TO PROTRUDE EQUALLY FROM THE CLAMPING RING. THE RING HAS TO BE ALIGNED PERPENDICULAR TO THE HANDLEBAR. ONLY HAND-SCREW THE GRUB SCREWS. IF TIGHTENED TOO FIRMLY THEY MAY DEFORM THE CLAMPING RING, PREVENTING THE GRIP FROM BEING ABLE TO BE SCREWED ONTO THE CLAMPING RING. DO NOT LET THE GRUB SCREWS PROTRUDE ABOVE THE EXTERNAL THREAD UNDER ANY CIRCUMSTANCES, THEY MIGHT DAMAGE THE THREADS OF THE GRIP WHEN MOUNTING.

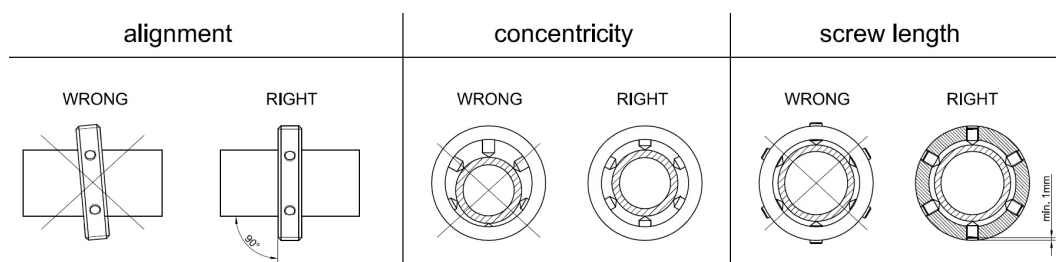

- Now carefully screw the grip **counter-clockwise** onto the clamping ring.

IMPORTANT! DO NOT USE TOOLS AND DO NOT APPLY FORCE. DISCONTINUE MOUNTING IF THE THREADING JAMS. CHECK THE CLAMPING RING FOR DEFORMATIONS, WEDGING OR LACK OF CONCENTRICITY. CHECK FOR GRUB SCREWS PROTRUDING INTO THE THREADING OF THE CLAMPING RING.

Mounting the right grip (onto throttle shell)

- clean throttle shell outside carefully with spirit
- remove protection foil on the rubber strip
- only for 22mm throttle shell: on the clamping ring installation spot attach the rubber strip on the throttle shell. Cut surplus rubber so that the strip does not overlap
- attach 6 grub screw 4mm long to the clamping ring. Push the clamping ring over the rubber strip and align the ring according the pen marking
- tighten the grub screws carefully and evenly, check often if the throttle shell can still turn easily
- Now carefully screw the grip **counter-clockwise** onto the clamping ring.

The motogadget team wishes you a safe and pleasant ride, enjoy your new "mo.grip" handlebar grips.

Declaration of Conformity

Hereby, motogadget GmbH declares the product is in compliance to EU directives.
The full text of the EU Declaration of Conformity is available at the following internet address:

<https://manuals.motogadget.com/mo-grip>

